

LTR	REV.	DESCRIPTION	DATE	APP'D

RoHS-COMPLIANT

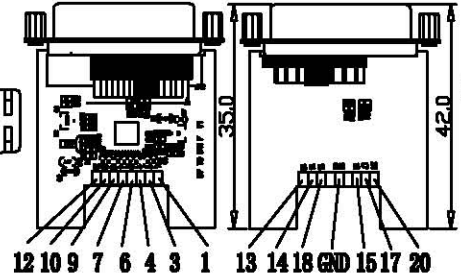

Assembly diagram:

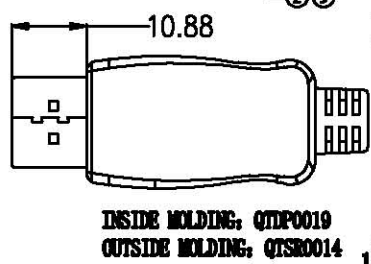
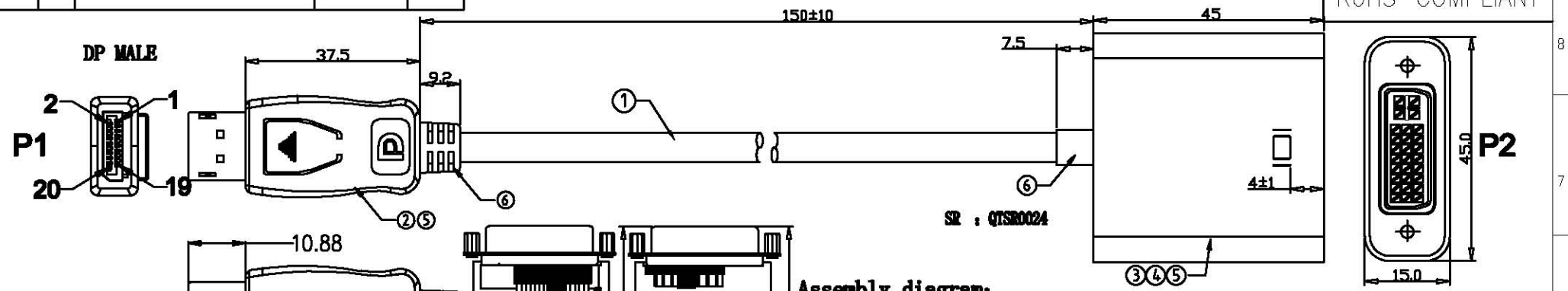
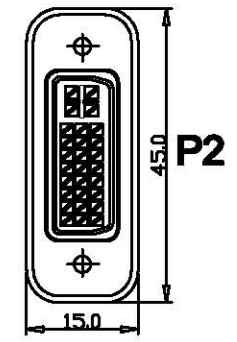
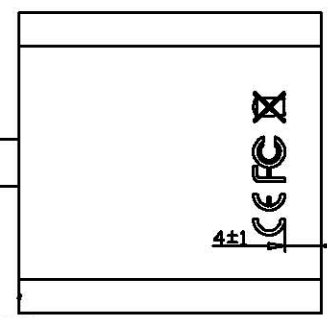
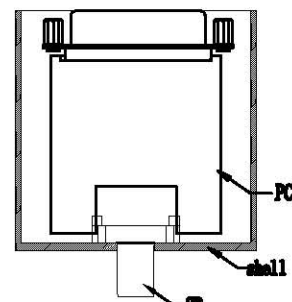

DVI Female

Remark: (DP TO DVI test)  
 1. UFGA: 1200\*720p, 1920\*1080P  
 2. Refresh rate:60HZ  
 3. DISPLAYPORT 1.1V

ELECTRICAL TEST:  
 1. 100% OPEN SHORT MIS WIRE TEST  
 2. CONTACT RESISTANCE:3 OHM MAX  
 3. INSULATION RESISTANCE:10M OHM MIN  
 4. HI-POT TEST:DC 300V/10ms

SHELL		BRAD	SHELL
2		DRAIN	GND
1		WHITE	1
3		RED	3
5		DRAIN	GND
4		WHITE	4
6		GREEN	6
8		DRAIN	GND
7		WHITE	7
9		BLUE	9
19		GREEN	GND
18		PURPLE	18
13		YELLOW	13
14		WHITE	14
11		DRAIN	HND
10		WHITE	10
12		BLACK	12
16		DRAIN	GND
15		WHITE	15
17		BROWN	17
20		RED	20

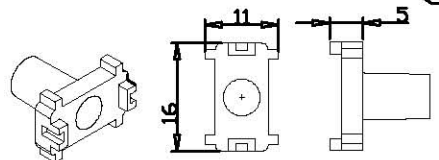

NO.	NAME	DESCRIBE	Q' TY	REMARK
6	MOLDING	Black 45P PVC		A/R
5	MOLDING	LDPE, Nature color		A/R
4	SHELL	DVI Female black main shell DVI Female black front shell	1	
3	PLUG	DVI (24+5)/F:G/R, Nickel plated, PCB'A (PSS121E)	1	
2	PLUG	DP 20P/M:G/R, Nickel plated, black ABS shell	1	
1	CABLE	UL20276 #32*5P+#32*5C+AEB, BLACK PVC JACKET, OD:5.0mm L=400mm (DOUBEL)	1	



NAME:  
AK3985

1.1V DP M to DVI FEMALE BLACK CABLE

Tol.	Inch	mm	UNIT	mm	DRAWING:	KENNY
X.	.02	0.5	ANGLE	±'	CHECK:	
X.X	.12	0.3	SCALE	NONE	RECHECK:	
X.XX	.008	0.2	POINT	NONE	APPROVE:	
X.XXX	.006	0.15			DATE	2017/04/06
X.XXX	.006	0.15			VERSION	A PAGE 1/1

