

1 2 3 4 5 6 7

A
B
C
D
E
F
G
H

A
B
C
D
E
F
G
H

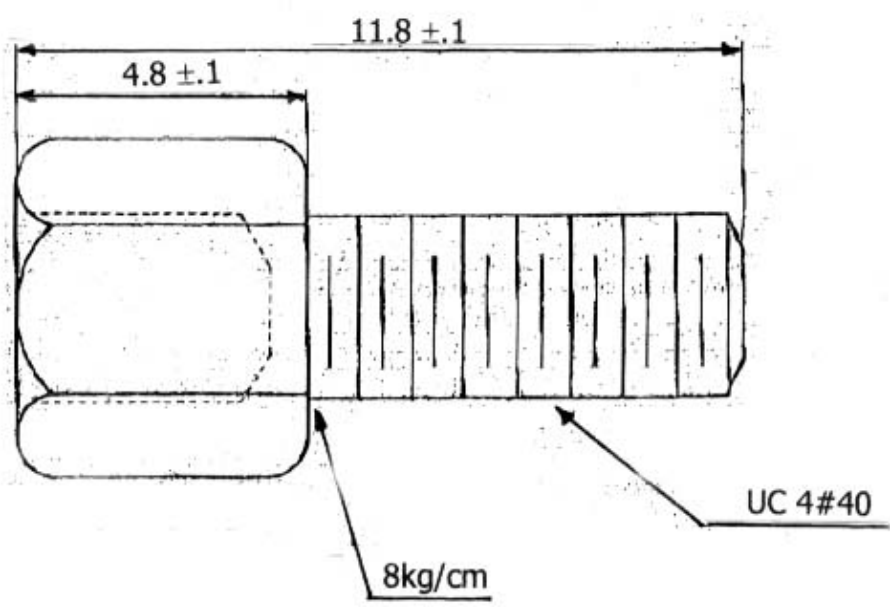
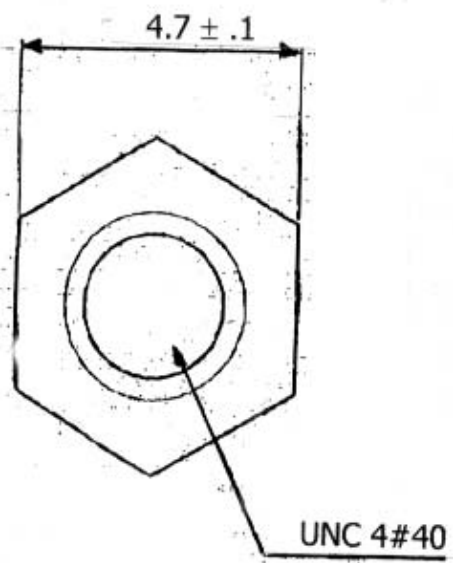

Material: Brass
 Finish: z = Zinc-
 c = Tin-plated with yellow chrome

Änderung	Datum	Name	Datum	Name	Benennung	
			Bearb.	22.02.99	Hellwig	
			Gepr.	22.02.99	Hellwig	
			Norm.			
ASSMANN Electronic Components					Zeichnungsnummer	Blatt
					ASS 0480 CO	1/1
					Ersatz für	Blatt

1 2 3 4 5 6 7

K

K